

Instruções de uso

ivKIT[®]

ACESSO PERIFÉRICO

PUNÇÃO GUIADA



ivKIT[®]
ACESSO PERIFÉRICO



01
Higienize as mãos

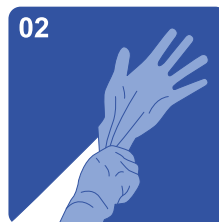

02
Coloque as luvas estéreis

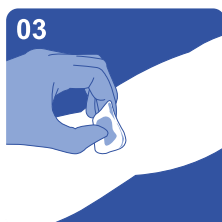

03
Faça a antissepsia da pele e descarte as luvas

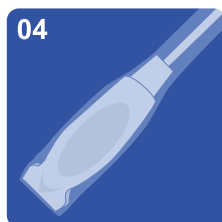

04
Calce o segundo par de luvas e prepare o transdutor

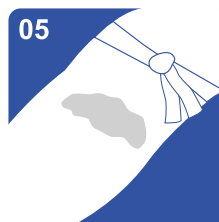

05
Aplique gel sobre a pele e prenda o garrote



06
Identifique o vaso

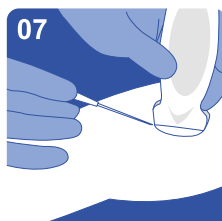

07
Realize a punção, observando o retorno venoso

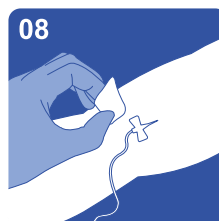

08
Aplique o protetor cutâneo



09
Consulte no verso a aplicação adequada do seu curativo

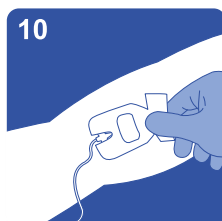

10
Aplique a estabilização / cobertura



11
Realize o flushing



Manter seco



Manter longe do calor



Não contém látex



Proibido reprocessar



Não reesterilizar



Não utilizar se a embalagem estiver danificada



Não contém DEHP

STERILE EO

8.02.00019.00
04/06/2020

OncoDerm® sem Fenestra

IMPORTANTE: Aplique o protetor cutâneo SafeNSimple™ e aguarde pela secagem completa.

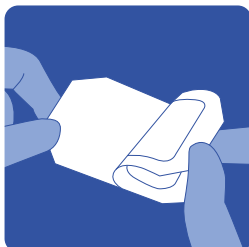

Remova a camada protetora



Posicione e aplique o curativo



Remova a borda do curativo

OncoDerm® Fenestrado

IMPORTANTE: Aplique o protetor cutâneo SafeNSimple™ e aguarde pela secagem completa.

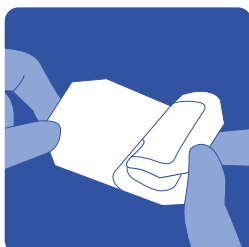

Remova a camada protetora

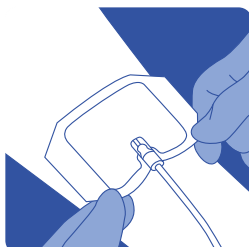

Posicione e aplique o curativo



Remova a borda do curativo

Securis™

IMPORTANTE: Aplique o protetor cutâneo SafeNSimple™ e aguarde pela secagem completa.

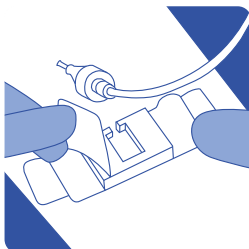

Aplique a base

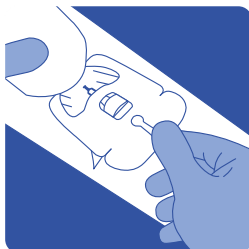

Aplique o curativo

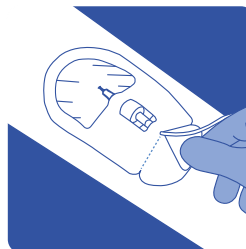

Cruze as abas sob o conector luer